



Ash Matters

The Ash Parish Council Newsletter

Issue Two 2018



The Friary Guildford Brass Band in Concert



**Sponsored by the Ash and Blackwater
Valley Rotary Club
With all proceeds going to**

STEP BY STEP

Young People. Hard Times. Bright Futures.



**Saturday 17th November 2018
The Ash Centre, Ash Hill Road,
Ash, Surrey**

6:30pm for 7:00pm

Refreshments available.

**Admission: by advance ticket £10.00
on the door £12.00**

**For tickets/more
information
telephone
01252 328287**



Chairman's Bit.

Ash Parish Council would like to hear residents opinions in connection with the Parish Newsletter "*Ash Matters*".



The Parish Newsletter was first published in 2003 when each issue was produced in black and white and consisted of just 4 pages. Since then, the number of pages has increased to 8 per issue and it is now produced in full colour.

Each issue currently costs £1,857.00 to produce and this covers both the printing and delivery, by external contractors. The Council has been advised that delivery charges are set to increase again and this means to produce 4 issues a year it will cost up to £7,428.00 per year.

At the beginning of the year, with this cost in mind, the Council took the decision to reduce the number of issues produced in 2018, from 4 issues per year to just 2.

In an attempt to keep costs down the Council is now considering other options with respect to the Newsletter, and would welcome your views and comments. For example, to produce a quarterly electronic version only, available via the Council's website (see below) would be significantly cheaper.

The Council would now like to hear your views with respect to the production of the Parish Newsletter and really looks forward to hearing from you. Please either write to us at the Ash Centre, Ash Hill Road, Ash, Surrey, GU12 5DP or by e-mail to office@ashpcsurrey.gov.uk clearly marking the subject as Parish Newsletter.

Closing date for your submissions is 31st December 2018.

Thank you
Nigel Manning
Chairman, Ash Parish Council.

The screenshot shows the first edition of the Ash Parish Newsletter. It features the Ash Parish Council logo, a welcome message from the Chairman, Nigel Manning, and a section titled 'Competition' for the 'Best Kept Hanging Basket'. The newsletter is dated 2002 and mentions that the Ash Parish Council won a Gold Medal Standard in the Best Kept Parish Category in 2002.

The screenshot shows the Ash Parish Council website. The 'Newsletters' section is highlighted, showing a list of newsletters from 2018, 2017, and 2016. The website also features a search bar, a sidebar with navigation links, and a section for 'PARISH DOCUMENTS'.

New Ash Road Bridge

The Ash Road Bridge project will deliver a new link road and road bridge over the railway line at Ash Station for pedestrians, cyclists and vehicles, allowing the level crossing to be closed, removing a key pinch point on the road network.

Network Rail as part of the project will build a new footbridge suitable for all users linking the platforms. This infrastructure scheme is essential to mitigate existing issues of a congestion pinch point and the rail barrier being down for a significant amount of time, plus mitigate the planned development proposed in Ash & Tongham in the Guildford Borough Council Submission Local Plan (Policy A29).

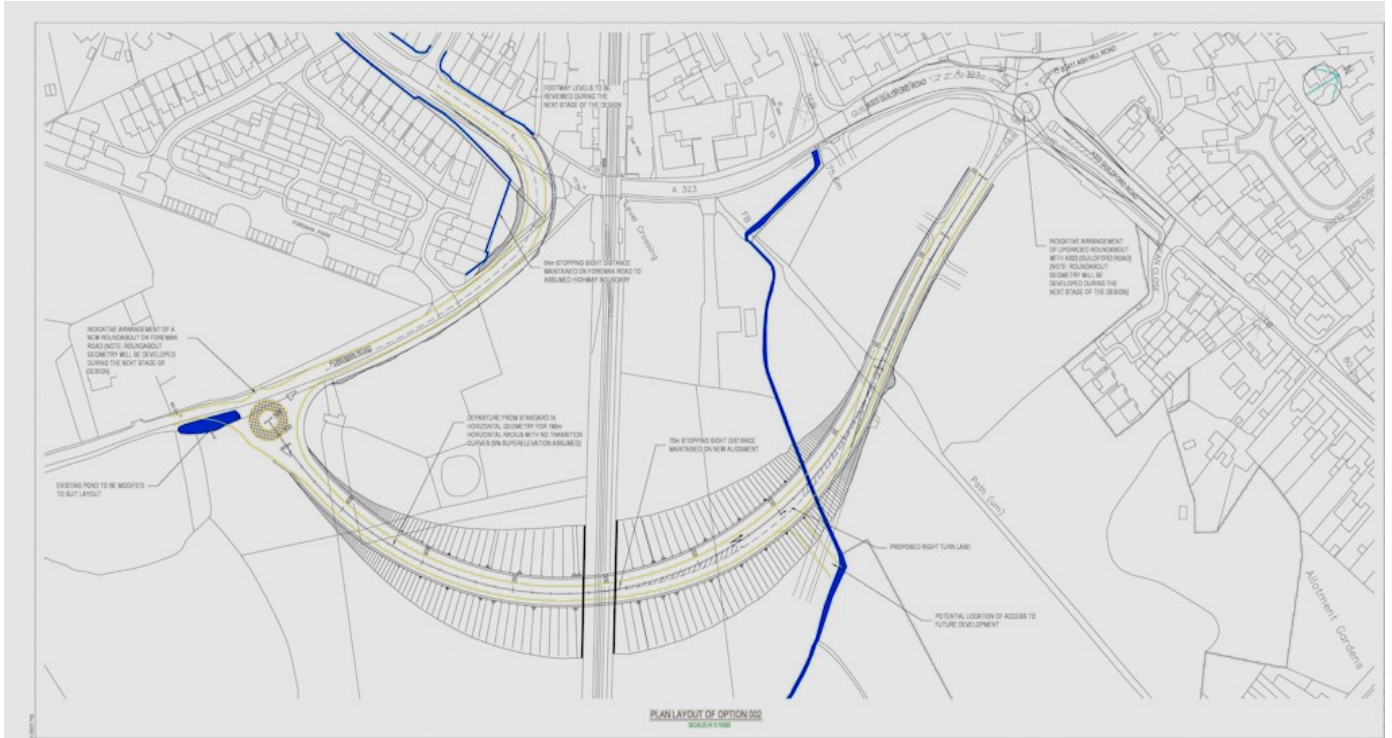

Proposed Route of Ash Bridge

Key benefits of the scheme include the removal of an existing traffic congestion hotspot delaying vehicles, pedestrians and cyclists and will provide an alternative route, encouraging traffic off rural roads to reduce rat running. The scheme facilitates the removal of a safety hazard posed by the present level crossing, categorised by Network Rail as a medium-high risk and will mitigate against further impacts of proposed additional passenger train services on the line in future (three times per hour off-peak).

The scheme is supported by Network Rail, who have pledged £2.5m funding. Homes England have also awarded £10m from the Housing Infrastructure Fund. The design is currently being developed for a planning application to be submitted in 2019. Construction is planned to commence in 2020 and be complete in 2021. This is a Guildford Borough Council led scheme to deliver key infrastructure in Ash.

A public update of the bridge project was given at the Ash Forum held on Wednesday 17th October at the Ash Centre. Details of the presentation made by Guildford Borough Council officers are available on Guildford Borough Council website <https://www.guildford.gov.uk/ashforum>.

If you have any questions regarding the project, please contact major.projects@guildford.gov.uk.

Dates for your 2018 Diary

Remembrance Day Service and Parade - Sunday 11th November 2018

Friary Guildford Brass Band Concert - Saturday 17th November 2018

Fantasia 2018 - Saturday 1st December 2018

ASH in BLOOM Presentation Evening 2018



This year's Ash in Bloom presentation evening took place on Wednesday 5th September at the Ash Centre. This year the event was sponsored by Dover Garage, Ash Hill Road, Ash. The prizes of Garden Vouchers were kindly offered by Squires Gardens Centre at a discount price. The certificates and prizes were presented by Alan Burrows from Dover Garage.



Dover Garage

Entrants either entered in their own right, were nominated by a third party or were a winner in Ash in Bloom 2017.

Judging of Ash in Bloom 2018 took place in secret during July and was undertaken by Hazel Chant from the Ash Garden Club. Hazel is also a judge for South and South East in Bloom. Hazel was looking at a number of criteria, including; quality of plants, diversity of plants, good use of colour, sustainability, including evidence of using water butts, and also the overall impression of the entry.



ASH in BLOOM Presentation Evening 2018

The presentation evening was compered by Chairman of the Council Cllr Nigel Manning and the evening was as usual split into 2 parts with the Village Fete Open Class winners receiving their certificates first and the Ash in Bloom winners receiving their certificates in the second part of the evening.

The standard of entries again this year was very good with entries in the Best Kept Allotment, Tubs and Containers, Hanging Baskets, Garden Border and also Best Front Garden classes. There was also an award for the best overall entrant.

Best Overall Entrant

David and Anne Stewart

Best Front Garden

Gold - David and Anne Stewart

Silver - Doreen Boxall

Silver - Susan DuBaree

Silver - Henry Gregory

Silver - Glenn and Nicola Philpott

Silver - Jean Fowler

Silver - John and Mary Dodd

Bronze - Martin Dunn and Pamela Gardner

Bronze - Gordon Haigh

Bronze - Ian and Valerie Caie

Best Garden Border

Silver - Susan DuBaree

Best Kept Allotment

Silver - Robert Anderson

Best Hanging Basket

Silver - Ian and Mary Cooper

Silver - Josephine Titmuss

Silver - Doreen Boxall

Silver - Margaret Haigh

Silver - George Cottrell

Silver - Darren Parsons

Silver - Susan DuBaree

Bronze - Brian Coutts

Best Tub/Container

Silver - Stephen Wade

Silver - Doreen Boxall

Silver - Brian Coutts

Silver - Margaret Haigh

Silver - Susan DuBaree

Silver - Elizabeth Ward

Bronze - Lynda Day



Remembrance Day Service and Parade



The 2018 Ash Parish Council Remembrance Day Service and Parade will be held on Sunday 11th November. The Parade will assemble at the Ash Centre and will leave for the War Memorial at 10:30. The Parade will include Parish Councillors, members of the armed forces, uniformed organisations and veterans, including members of U3A.



The names of the fallen who are listed on the War Memorial and died between November 1917 and November 1918 will as in previous years be read out by pupils from Ash Manor School.

Following the Service the congregation will parade back to the Ash Centre for a formal dismissal by the parade marshal. Tea and coffee will then be available at the Ash Centre where everyone

will be welcome. For further details of the Parade and Service please visit the Council Website www.ashpcsurrey.gov.uk. Or telephone 01252 328287.

Christmas Fantasia 2018



*Ash Wharf - Fantasia 2017
Picture: Neil Bidwell*

The 2018 Ash Parish Council Christmas Fantasia will be held on Saturday 1st December. The event will open with the traditional Christmas Fair at the Ash Centre from 2:00pm until 6:00pm. There will be a wide range of games, tombola's and gift stalls for those elusive Christmas presents. Refreshment will be available throughout the afternoon.

From 4:30pm there will be community carol singing on Ash Wharf around the Christmas Tree, with the music being provided by the Ash Vale Ensemble. Father Christmas will arrive at 5:00pm and as well as handing out sweets to the children on his journey to the tree from his "sleigh", he will following the traditional countdown, switch on the Christmas tree lights.

After the light switching on ceremony, mulled wine and mince pies (once again provided by the Co-op on Ash Wharf), will be available at the Ash Centre. Everyone is welcome.

Residents and business owners in the area around Ash Wharf and Wharf Road should be aware that there will be a road closure order in place on the length of Wharf Road between 4:15pm and approx. 5:30pm. Pedestrian and emergency services access will be available at all times.

For more information please visit www.ashpcsurrey.gov.uk, e-mail office@ashpcsurrey.gov.uk or telephone 01252 328287.

New Guildford Community Lottery



Guildford Borough Council launched its new online lottery called the Guildford Community Lottery at an event attended by over 70 local charities and organisations on Monday 24 September.

The lottery has been set up to help local charities, community and voluntary organisations, sports clubs, arts groups and other good causes to raise funds. Tickets will cost £1 with 60p going towards local good causes, compared to just 28p in the pound for the National Lottery. The draw will be weekly with a jackpot of £25,000 for a matching sequence of six numbers, other prizes being £2,000, £250, £25 or three free tickets. The first draw is planned for Saturday 1 December.

Relevant local organisations are still being encouraged to sign-up to benefit from the lottery at www.guildford.lottery.org.uk.

Generous partners help with funding

The “Silent Soldiers” seen around the Parish commemorate the 100 year anniversary of the end of the First World War and are a poignant reminder of the many lives lost during all conflicts. The Silent Soldiers were sourced from the Royal British Legion and were kindly sponsored by Surrey County Council’s Members’ Allocation Fund through Councillor Marsha Moseley.

Guildford Borough Council has also helped support various projects across Ash with their grant aid scheme for Parish Councils. Most recently these projects include our street lighting replacement programme, new play equipment, surveillance cameras, new tables for the Ash Centre and new computers for the Parish Council offices.

An exciting new piece of play equipment has very recently been installed at Ash Hill Recreation Ground by manufacturer HAGS SMP. The four metre high play pyramid is made from nylon braided, six strand core wire rope with aluminium supports connected to a stainless steel mast. It is designed to offer an exciting challenge for 5-12 year olds. Imagine it as a mountain, a giant tree or an army assault course. There are endless spatial, physical and mental challenges for individuals and groups of children. With its new safety surfacing and other associated costs the play equipment was £18,000 and Guildford Borough Council has generously granted £5,000 towards the cost.

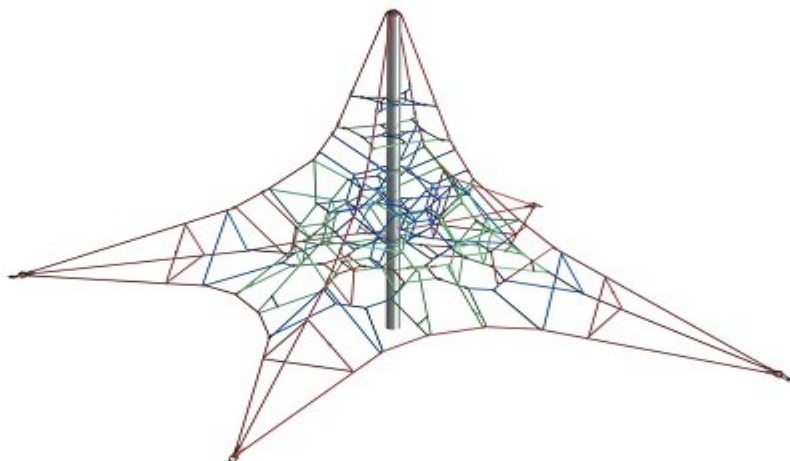

Ash Parish Council Contact Details

Clerk to Ash Parish Council
 Ash Centre, Ash Hill Road, Ash, Surrey. GU12 5DP
 Telephone: 01252 328287
 Fax: 01252 319338
 E-mail: office@ashpcsurrey.gov.uk
 Website: www.ashpcsurrey.gov.uk
 Twitter: [@ashpcsurrey](https://twitter.com/ashpcsurrey)



**SURREY
POLICE**
 With you, making
 Surrey safer

Contact Numbers

999 or 112 - For all emergencies
101 - Report a non emergency crime to Surrey Police

Community Wardens

07901 513652 - CW Jo Packman
07769 642053 - CW Lesley Telford

Dates for your 2018 Diary

Remembrance Sunday Parade and Service

Sunday 11 November 2018

Friary Guildford Brass Band Concert

Saturday 17 November 2018

Christmas Fantasia

Saturday 1 December 2018

Visit www.ashpcsurrey.gov.uk for news of any other events

Recycling Sites

Recycling in Ash Parish is handled by Guildford Borough Council. There is an extensive section on recycling on the following webpage: <http://www.guildford.gov.uk/guildfordweb/environment/recycling>.

Community Recycling sites in Ash and Ash Vale are located at:

Ash Football Club

Shawfield Road

Green, Brown and Clear Glass.



Carrington Recreation Ground

Lysons Avenue

Green, Brown, Clear Glass, Newspapers,
 Magazines, Cans, Plastic Bottles, Textiles, Shoes.

Coronation Gardens

Ash Hill Road

Green, Brown, Clear Glass, Newspapers, Magazines, Cans, Plastic
 Bottles, Cardboard, Textiles and Shoes, Liquid Food Cartons
 and Drink Cartons.

If you would like to place an article or advertisement about a community event in a future issue of this newsletter, or if you have any suggestions for improving the newsletter or website, please contact The Parish Office by telephone on: 01252 328287 or e-mail office@ashpcsurrey.gov.uk

Ash Parish Councillors

Telephone No.

E-mail

Ward

Cllr Paul Spooner	01252 338585	paul.spooner@guildford.gov.uk	Ash Rowan Ward
Cllr Martin Burgess	07881 910797	martinburgess@gmail.com	Ash South Ward
Cllr Nigel Kears	07941 878789	nigel.kearseapc@hotmail.com	Ash South Ward
Cllr Mrs Jo Randall	01252 344929	jo_randall@yahoo.co.uk	Ash South Ward
Cllr Laurence Armes	01252 662956	laurence.ames@ntlworld.com	Ash Vale Ward
Cllr Nigel Manning	01252 665999	nigel.manning@guildford.gov.uk	Ash Vale Ward
Cllr Mrs Marsha Moseley	01252 665999	marsha.moseley@guildford.gov.uk	Ash Vale Ward
Cllr John Tonks	07754 679296	john.tonks@gmail.com	Ash Vale Ward
Cllr Bill Cole	01252 664675	bill_cole@tinyworld.co.uk	Ash Wharf Ward
Cllr Andrew Gomm	01252 316411	Andrew.gomm.AG@gmail.com	Ash Wharf Ward
Cllr Mrs Jayne Hewlett	01252 328287	jbonilla.ashparish@gmail.com	Ash Wharf Ward
Cllr Mrs Pat Scott	01252 324941	scott.lpd@btinternet.com	Ash Wharf Ward