

NEW ROAD LAYOUT

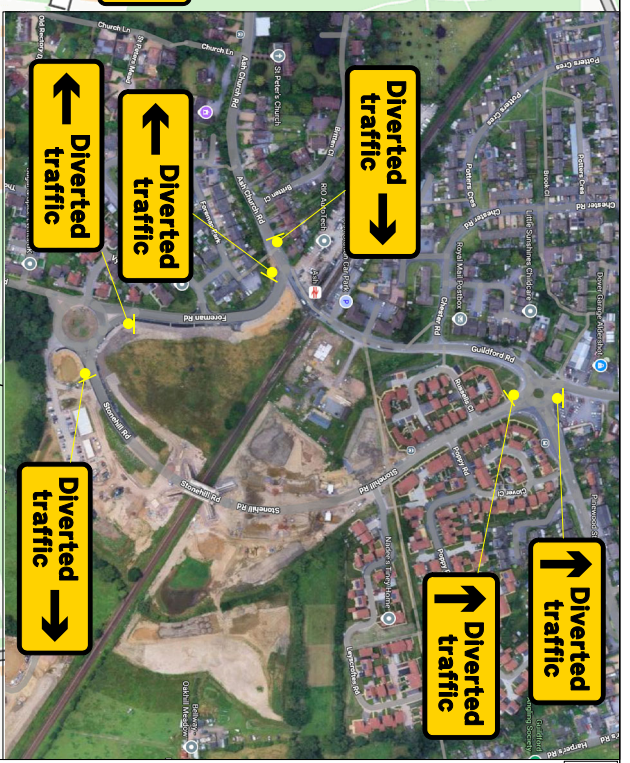

LOADING LIST

Dw/ 2 Ref: 13.9 Schedule 13.9 - Temporary Information	
Dw/ 2 Ref: 13.9 Schedule 13.9 - Temporary Information	
Dw/ 7 Ref: 13.9 Schedule 13.9 - Temporary Information	
Dw/ 5 Ref: 2706 Start of temporary diversion route	
Dw/ 6 Ref: 2707 Start of temporary diversion route	
Dw/ 2 Ref: 2702 End of temporary diversion route	
Dw/ 2 Ref: 2703 Diversion of temporary diversion route from junction ahead	
Dw/ 2 Ref: 2703 Diversion of temporary diversion route from junction ahead	
Dw/ 2 Ref: 2703 Diversion of temporary diversion route from junction ahead	
Dw/ 1 Ref: 573 Diversion to treated left	
Dw/ 1 Ref: 573 Diversion to treated right	
Dw/ 2 Ref: 7001 Road works ahead	
Dw/ 2 Ref: 7008 Lane closure ahead	

Centurion Traffic Management
30B, High Park Road
Snoiton
Leeds
LS10 1RT
Tel: 0113 277 5360
E-mail: info@centuriontraffic.com
www.centuriontraffic.com

CENTURION
TRAFFIC MANAGEMENT

Crown Copyright. All rights reserved.
Drawing to be read in conjunction with relevant method statement and risk assessment.
Unauthorised reproduction infringes Crown Copyright and may lead to prosecution or civil proceedings.

All dimensions to be verified on site

Centurion Website
For more information on our services, please use QR codes to access our website, latest brochure and the latest technology available.

Site Location
Shawfield Rd Railway, B3206, Ash, Aldershot GU12 6SQ

Drawing Reference Number
CTM/29-01/004

Scale A3 - NTS

Drawn by	BW	29/01/2026
Authorised by	M/H	29/01/2026
Amended by	N/A	N/A

Minimum sideways safety zone (m) **0.5**

Minimum longways safety zone (m) **0.5**

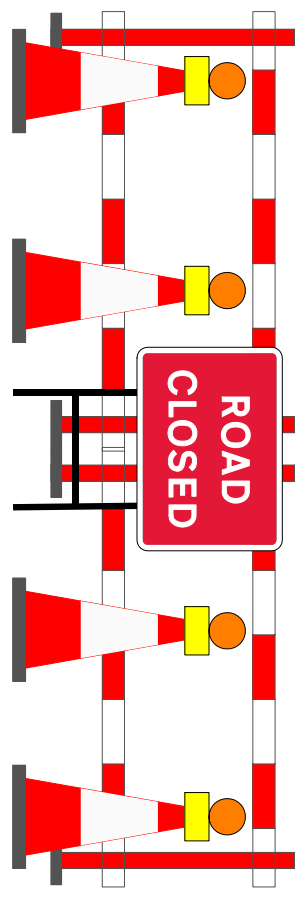

KEY

- Work area
- Pedestrian barrier
- Safety Zone
- Cones